

Sealed Deep Groove Ball Bearings

NACHI

NSE Seal



- Triple Seal Lips
- U-Shape Seal Groove
- Breathing Mechanism *
(on seal O.D.)

Advanced Seal Design Provides Excellent Protection and Smooth Operation

*The combination of a unique lip design and seal groove provides a labyrinth and steady seal contact.
Breathing mechanism avoids torque increases caused by
internal pressure variation due to changes in operating temperatures.
NSE seals allow NACHI bearings to have constant smooth operation and long service life.*

- Superior in Sealing Out Dust, Dirt, and Contamination
- Superb Grease Retention
- Light Torque

The Best Components Yield the Greatest Bearing Performance

*Rings and balls made of select material have superbly controlled accuracy such as roundness, contour,
surface finish, and hardness to provide quieter operation, reduced vibration levels, and long life.
Rivet-type pressed steel cages for strength and durability.
High-performance grease for long life and low noise.*

Note : * Non-breather type seals are available for applications in severe water contact environments or outer ring rotation.

Comparison Test Results

Nachi vs. Other Brands

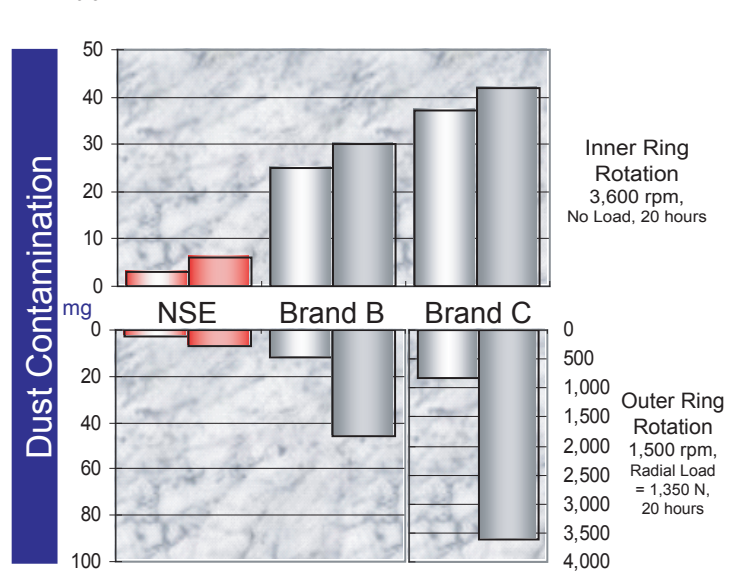
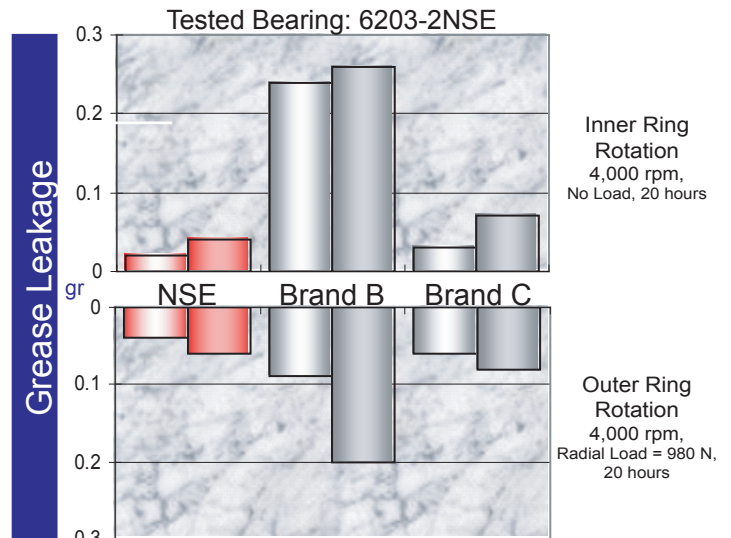
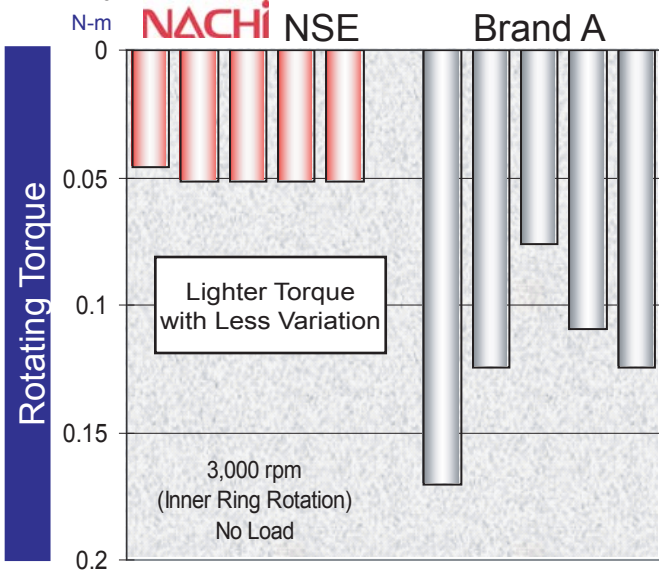
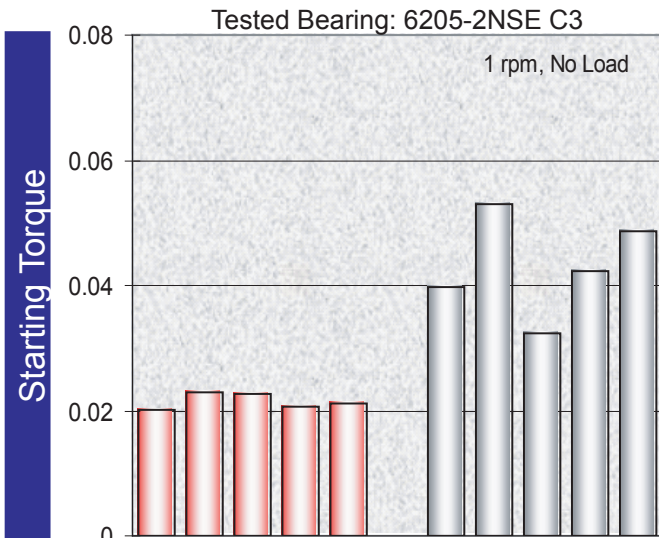

With **NACHI NSE** Sealed Bearings, **more than 20W of energy can be saved** per bearing at 3,000 rpm.

NACHI NSE Seals showed the best performance for retaining grease and avoiding the entrance of dust in these conditions.

Offices

BEARING DIV. HEADQUARTERS

715 Pushville Road
Greenwood, IN 46143
Phone: 888-340-2747
Fax: 888-734-1206

ENGINEERING LABORATORY

Nachi Technical Center
715 Pushville Road
Greenwood, IN 46143
Phone: 317-535-3675
Fax: 317-535-3659



WEST COAST OFFICE

12652 Alondra Boulevard
Cerritos, CA 90703
Phone: 800-548-3903
Fax: 562-802-2455

Shielded Deep Groove Ball Bearings

NACHI

ZE Shield



- L-Shaped Shield Plate
- U-Shaped Seal Groove

Advanced Shield Design Provides Superior Protection and Quiet Operation

The shield design was optimized using finite element analysis and dynamic analysis modeling techniques. The design profile and plate thickness provides rigidity that helps quiet operation as well as retain grease and protect against intrusion of major contamination.

- Superior in Sealing Out Contamination
- Superb Grease Retention
- Quiet Operation

The Best Components Yield the Greatest Bearing Performance

Rings and balls made of select material have superbly controlled accuracy such as roundness, contour, surface finish, and hardness to provide quieter operation, reduced vibration levels, and long life. Rivet-type pressed steel cages for strength and durability. High-performance grease for long life and low noise.

Comparison Test Results Nachi vs. Other Brands

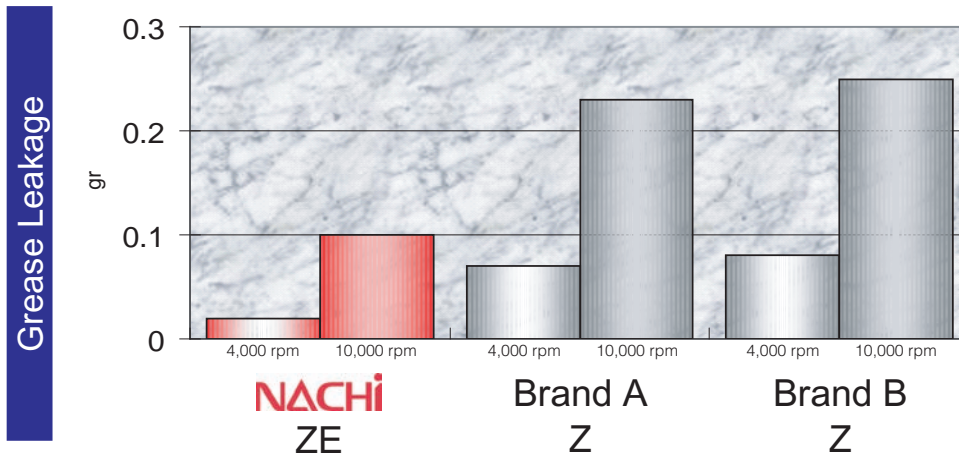

Tested Bearing: 6203ZZE
 Inner Ring Rotation, No Load
 Ambient Temperature = 80 °C
 Test Duration = 20 hours

NACHI ZE shield showed the best performance for retaining grease under both conditions.

Design Comparison

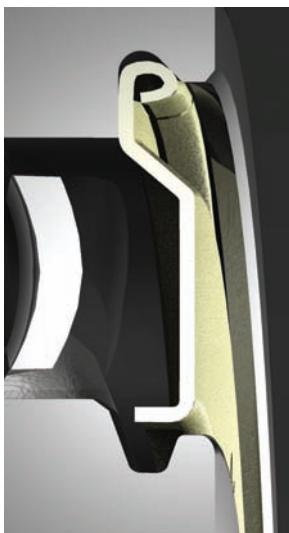

NACHI
ZE



Brand A
Z

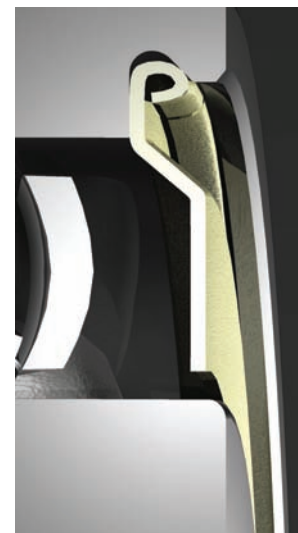

Brand B
Z

Offices

BEARING DIV. HEADQUARTERS

715 Pushville Road
 Greenwood, IN 46143
 Phone: 888-340-2747
 Fax: 888-734-1206



WEST COAST BRANCH

12652 Alondra Boulevard
 Cerritos, CA 90703
 Phone: 800-548-3903
 Fax: 562-802-2455

ENGINEERING LABORATORY

Nachi Technical Center
 715 Pushville Road
 Greenwood, IN 46143
 Phone: 317-535-3675
 Fax: 317-535-3659